



LORO-RAINSTAR® parapet drains, with installation depth 55 mm,

made of stainless steel, with clamping flange,
according to DIN EN 1253,
for bituminous and plastic roofing sheets

for gravity and siphonic flow

• **as main drainage**



for gravity flow

discharge rate as

main drainage:

DN 70 = 5.0 l/s*

DN 100 = 4.9 l/s*

discharge rate as

emergency drainage

DN 70 = 8.2 l/s*

DN 100 = 8.0 l/s*

for siphonic flow

discharge rate as

main drainage:

DN 70 = 15.6 l/s*

DN 100 = 14.0 l/s*

discharge rate as

emergency drainage:

DN 70 = 17.6 l/s*

DN 100 = 23.0 l/s*

Advantages:

- small roof penetration - due to flat version with only 55 mm installation depth
- break-proof, shockproof and treadable due to UV-resistant hood made of stainless steel
- CAD-precise complete system with reliable proof of performance
- only one sealing level plus 45° or 90° upstand as installation aid
- integrated weir under the hood (of the emergency drain)
- main and emergency drain at the same level
- pressure-resistant steel discharge pipe system according to DIN EN 1123

Series 89 RAINSTAR® with small penetration depth

Type	Main drainage				Emergency drainage							
	Gravity flow		Siphonic flow		Gravity flow		Siphonic flow					
	Silent Power				Silent Power							
	01362X		01366X		01363X		01367X					
	01360X		01364X		01361X		01365X					
	DN	70	100	70	100	70	100	70	100			
Roof penetration depth	55 mm	55 mm	55 mm	55 mm	55 mm	55 mm	55 mm	55 mm				
Water height (mm)	35	35	55	55	75	75	75	75				
Weir height (mm)	0	0	0	0	35	35	55	55				
LX-No.	LX471	LX472	LX487	LX488	LX473	LX665	LX475	LX476	LX668	LX667	LX798	LX666
Discharge Q (l/s)	5.0 l/s *		2.7 l/s **		4.9 l/s *		3.6 l/s **		15.6 l/s *		14.0 l/s *	
	8.2 l/s *		3.5 l/s **		8.0 l/s *		4.6 l/s **		17.6 l/s *		23.0 l/s *	

= as spout

* Discharge capacity in keeping with test specification according to DIN EN 1253, downpipe length 4.2 m

** LORO measurement with fully ventilated downpipe, corresponds to spout capacity

Examples of Application

LORO-RAINSTAR® parapet drains, DN 70 and DN 100, with clamping flange, with installation depth 55 mm, as special version, according to DIN EN 1253

for bituminous and plastic roofing sheets
For gravity flow

- 1 LORO-RAINSTAR® parapet drain
- 2 Bituminous roofing sheets
- 3 Thermal insulation
- 4 Vapor barrier
- 5 Trapezoidal sheet industry roof
- 6 LORO sliding flange (for installation of the vapor barrier)
- 7 LORO-X branch, 87°
- 8 LORO-X rain downpipe
- 9 LORO-X rain standpipe
- 10 LORO-X pipe
- 11 Ground pipe

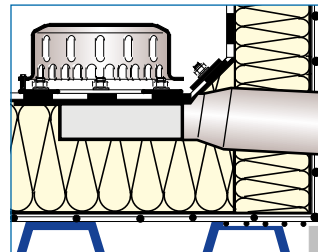
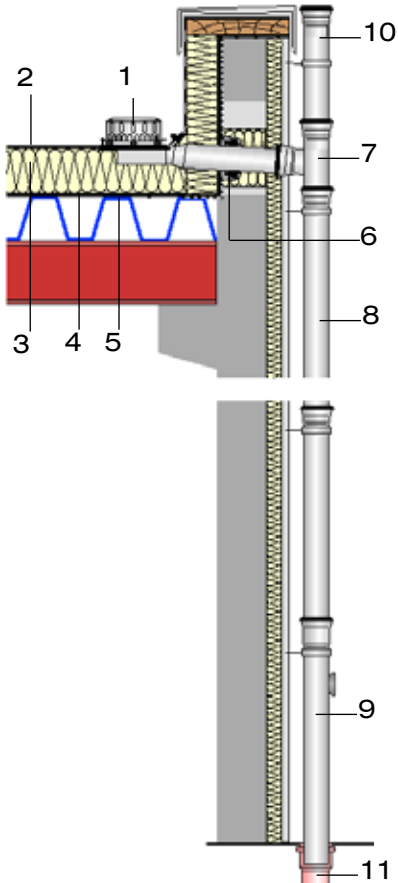

For roof sealing with bituminous roofing sheets

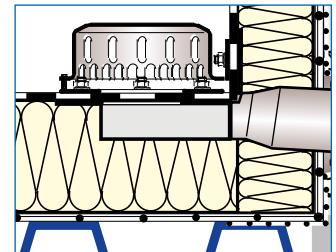

For roof sealing with plastic roofing sheets

LORO-RAINSTAR® parapet drains, as emergency drains, DN 70 and DN 100, with clamping flange, with installation depth 55 mm, as special version, according to DIN EN 1253

for bituminous and plastic roofing sheets
For siphonic flow

- 1 LORO-RAINSTAR® parapet emergency drain
- 2 Bituminous roofing sheets
- 3 Thermal insulation
- 4 Vapor barrier
- 5 Trapezoidal sheet industry roof
- 6 LORO sliding flange (for installation of the vapor barrier)
- 7 LORO-X bend, 87°
- 8 LORO-X rain downpipe
- 9 LORO-X bend, 45°

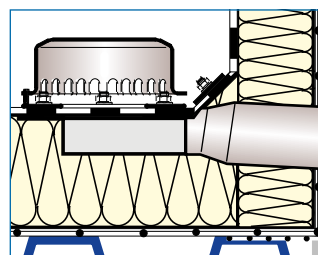
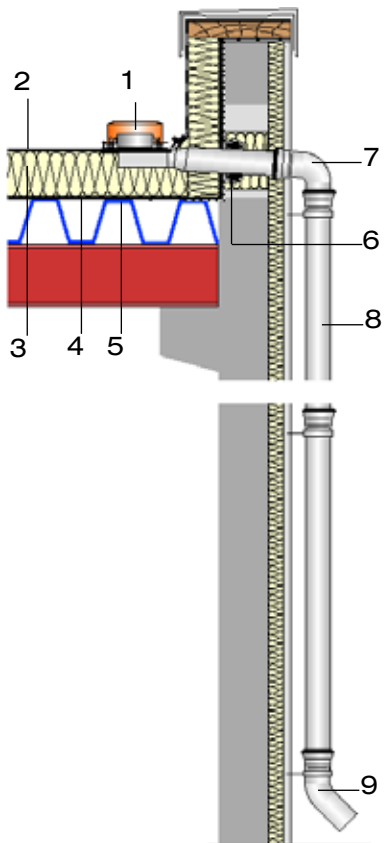

For roof sealing with bituminous roofing sheets

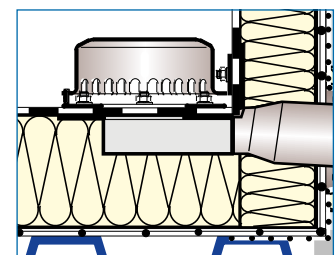

For roof sealing with plastic roofing sheets

Dimensions and Weights

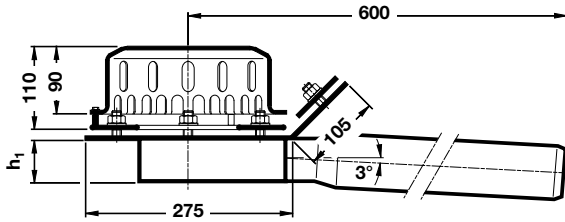

LORO-RAINSTAR® parapet drains, DN 70 and DN 100, with clamping flange, with installation depth 55 mm, Series 89 for bituminous roofing sheets

made of stainless steel

consisting of:
strainer basket, loose flange, drain body

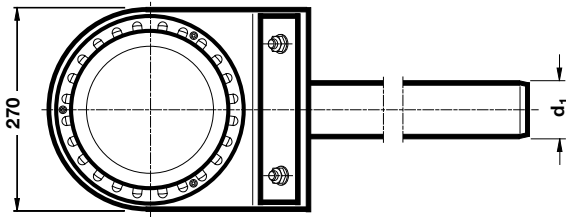

Discharge rate according to specification sheet:

LX 471	DN 70:	5.0 l/s*
LX 472	as spout:	2.7 l/s
LX 487	DN 100:	4.9 l/s*
LX 488	as spout:	3.6 l/s

DN 70:	Art-No. 01360.070X	weight:	5.4 kg
DN 100:	Art-No. 01360.100X	weight:	5.7 kg

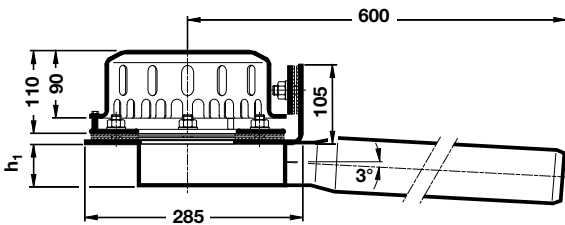

LORO-RAINSTAR® parapet drains, DN 70 and DN 100, with clamping flange, with installation depth 55 mm, Series 89 for plastic roofing sheets

made of stainless steel

consisting of:
strainer basket, loose flange, compression seals, drain body

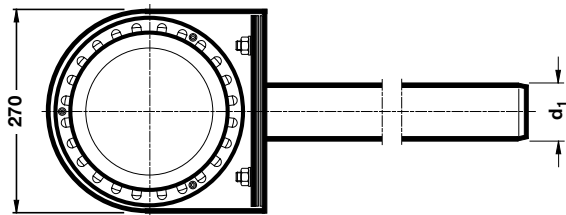

Discharge rate according to specification sheet:

LX 471	DN 70:	5.0 l/s*
LX 472	as spout:	2.7 l/s
LX 487	DN 100:	4.9 l/s*
LX 488	as spout:	3.6 l/s

DN 70:	Art-No. 01362.070X	weight:	5.6 kg
DN 100:	Art-No. 01362.100X	weight:	5.9 kg

DN	d ₁	h ₁
70	73	55
100	102	60

* In compliance with test specification according to DIN EN 1253

Dimensions and Weights

LORO-RAINSTAR®
parapet emergency drains,
DN 70 and DN 100,
with clamping flange,
with installation depth 55 mm,
Series 89
for bituminous roofing sheets

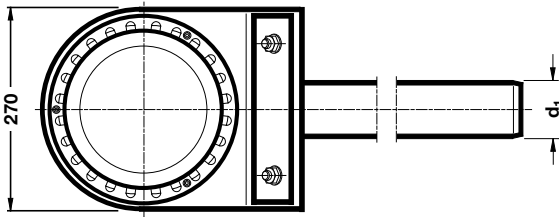
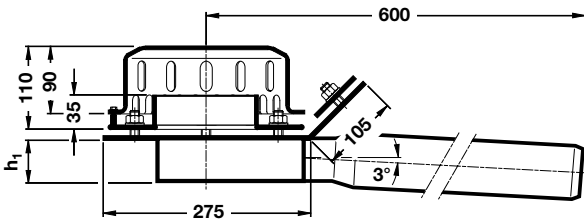

made of stainless steel

consisting of:
 strainer basket, loose flange with congestion element,
 drain body, loose flange for drain body

Discharge rate according to specification sheet:

LX 475	DN 70:	8.2 l/s*
LX 476	as spout:	3.5 l/s
LX 668	DN 100:	8.0 l/s*
LX 667	as spout:	4.6 l/s

DN 70:	Art-No. 01361.070X	weight:	5.5 kg
DN 100:	Art-No. 01361.100X	weight:	5.8 kg

LORO-RAINSTAR®
parapet emergency drains,
DN 70 and DN 100,
with clamping flange,
with installation depth 55 mm,
Series 89
for plastic roofing sheets

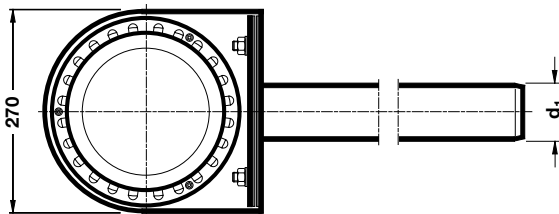
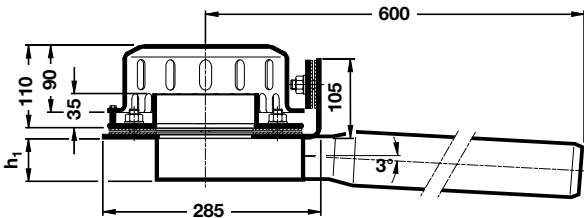

made of stainless steel

consisting of:
 strainer basket, loose flange with congestion element,
 compression seals, drain body, loose flange for drain body

Discharge rate according to specification sheet:

LX 475	DN 70:	8.2 l/s*
LX 476	as spout:	3.5 l/s
LX 668	DN 100:	8.0 l/s*
LX 667	as spout:	4.6 l/s

DN 70:	Art-No. 01363.070X	weight:	5.7 kg
DN 100:	Art-No. 01363.100X	weight:	6.1 kg

DN	d ₁	h ₁
70	73	55
100	102	60

* In compliance with test specification according to DIN EN 1253

Dimensions and Weights

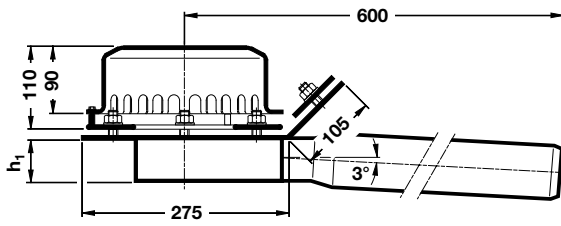

LORO-RAINSTAR® parapet drains, DN 70 and DN 100, with clamping flange, with installation depth 55 mm, Series 89 for bituminous roofing sheets

made of stainless steel

consisting of:
strainer basket, loose flange, drain body

Discharge rate according to specification sheet:

LX 473 DN 70: 15.6 l/s*
LX 665 DN 100: 14.0 l/s*

DN 70: [Art-No. 01364.070X](#) weight: 5.5 kg
DN 100: [Art-No. 01364.100X](#) weight: 5.8 kg

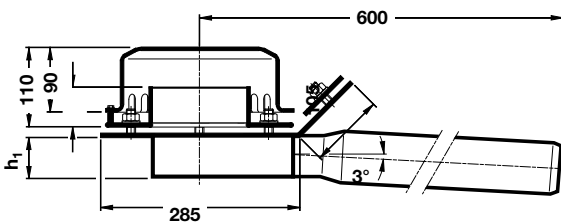
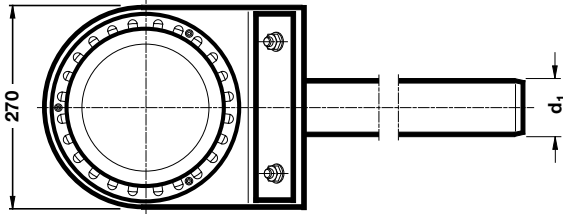

LORO-RAINSTAR® parapet drains, DN 70 and DN 100, with clamping flange, with installation depth 55 mm, Series 89 for plastic roofing sheets

made of stainless steel

consisting of:
strainer basket, loose flange, compressions seals, drain body

Discharge rate according to specification sheet:

LX 473 DN 70: 15.6 l/s*
LX 665 DN 100: 14.0 l/s*

DN 70: [Art-No. 01366.070X](#) weight: 5.7 kg
DN 100: [Art-No. 01366.100X](#) weight: 6.0 kg

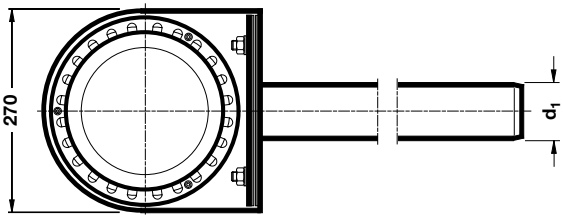

DN	d ₁	h ₁
70	73	55
100	102	60

* In compliance with test specification according to DIN EN 1253

Dimensions and Weights

LORO-RAINSTAR® parapet emergency drains, DN 70 and DN 100, with clamping flange, with installation depth 55 mm, Series 89 for bituminous roofing sheets

made of stainless steel

consisting of:
strainer basket, loose flange with congestion element,
drain body, loose flange for drain body

Discharge rate according to specification sheet:

LX 798	DN 70:	17.6 l/s*
LX 666	DN 100:	23.0 l/s*

DN 70:	Art.-No. 01365.070X	weight:	5.7 kg
DN 100:	Art.-No. 01365.100X	weight:	6.0 kg

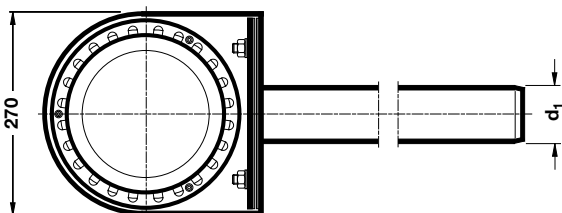
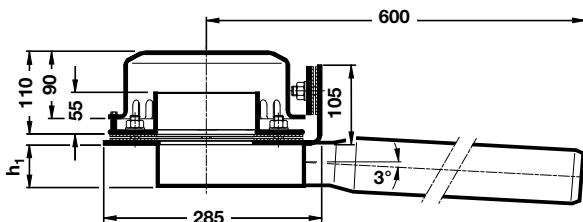
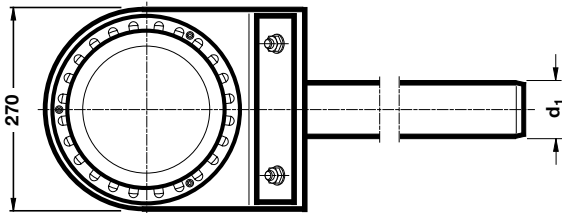
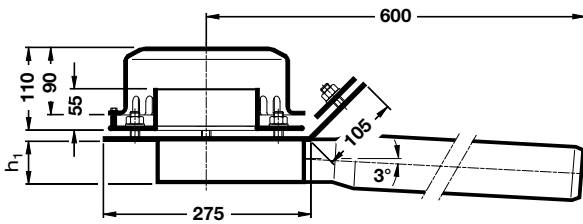

LORO-RAINSTAR® parapet emergency drains, DN 70 and DN 100, with clamping flange, with installation depth 55 mm, Series 89 for plastic roofing sheets

made of stainless steel

consisting of:
strainer basket, loose flange with congestion element,
compression seals, drain body, loose flange for drain body

Discharge rate according to specification sheet:

LX 798	DN 70:	17.6 l/s*
LX 666	DN 100:	23.0 l/s*

DN 70:	Art.-No. 01367.070X	weight:	5.9 kg
DN 100:	Art.-No. 01367.100X	weight:	6.2 kg

DN	d ₁	h ₁
70	73	55
100	102	60

Advantages of LORO-X pipe systems made of steel with LORO-X push-fit socket

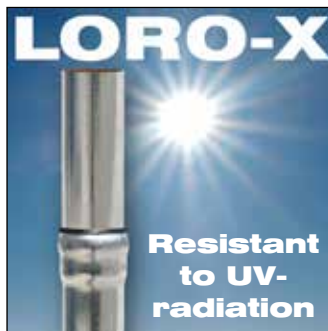
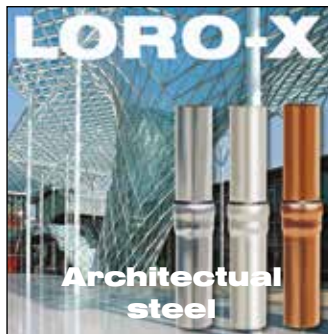
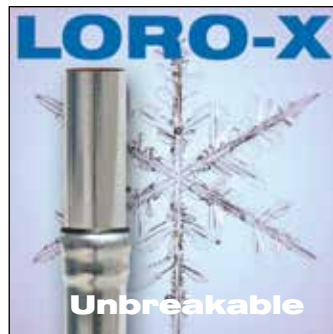
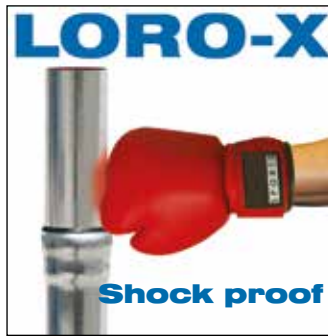

Please contact us for further information or for placing an order:

**LOROWERK
K.H. Vahlbrauk GmbH & Co. KG**

Kriegerweg 1 • 37581 Bad Gandersheim,
Postfach 13 80 • 37577 Bad Gandersheim
Tel. +49 5382 71 0 • Telefax +49 5382 71 203
Internet: www.loro-x.com • e-mail: infocenter@lorowerk.de